

# Low Voltage Products

## HRC Fuse Links OFAFN\_ and OFFN\_ DIN and BS types, gG





# Fuse protection - safe and reliable

## 2A...1250 A, 500 V

### DIN-Type HRC fuse links (blade-type), 2A...1250 A, 500 V

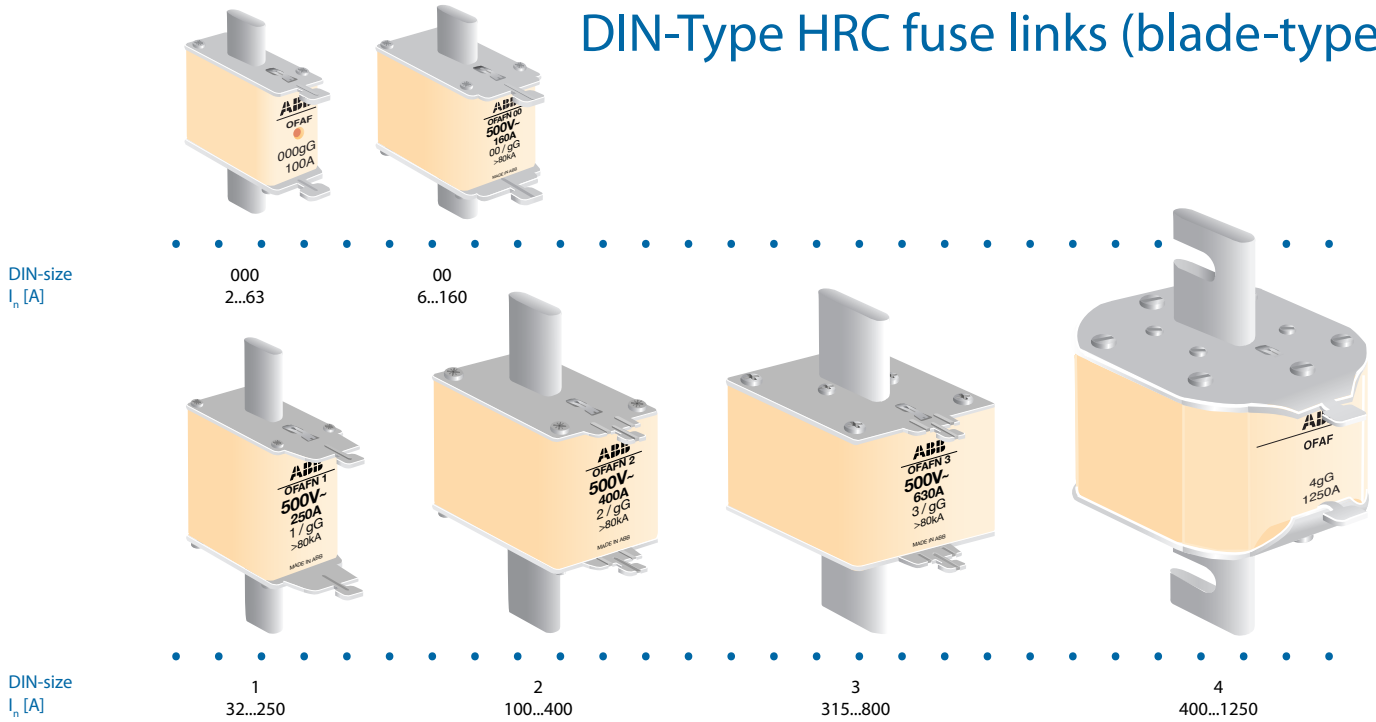

### BS-Type HRC fuse links (bolted-type), 2A...800 A, 500 V

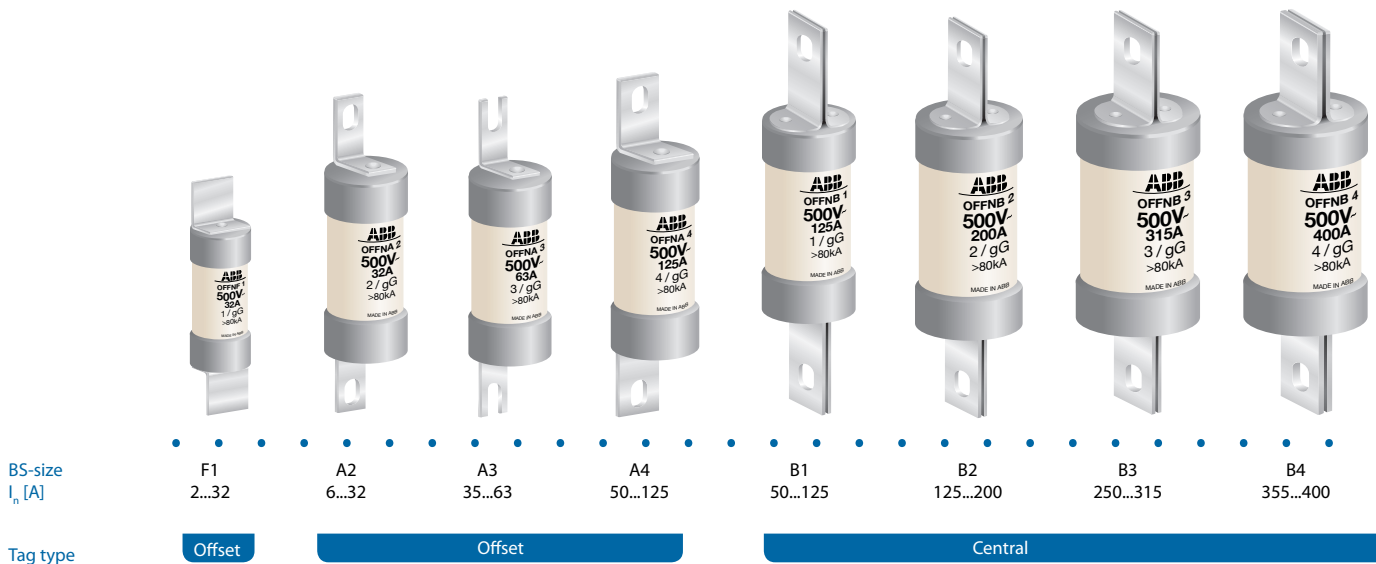

and reliable

...1250 A, 500 V

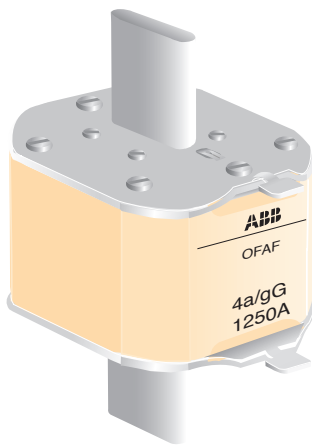

4a  
500...1250



C2  
400...800



## HRC fuse links

DIN and BS-type

OFAFN\_ and OFAF\_

OFFN\_

### Contents:

Features.....	4
Ordering information.....	5-6
DIN-type OFAFN_ and OFAF_ fuse links, type gG, 500 V.....	5
BS-type OFFN_ fuse links, type gG, 500 V.....	6
Time-current characteristics.....	7-8
Cut off -current characteristics.....	9
I <sup>2</sup> t -values.....	10
Dimension drawings.....	11

## 2A...1250 A, 500 V

- ▶ Total safety for your cables, motors and electronics protection.
- ▶ Wide and dense current ratings for optimal dimensioning of other circuit components.
- ▶ Low let through energy, low cut off characteristics, reduced electro magnetic stress.
- ▶ Energy saving through low power losses.
- ▶ No deration required for connected equipment in normal situation.
- ▶ High breaking capacity 80 kA at 500 V (AC).
- ▶ Fault indication on the top of the fuse link.
- ▶ Confirm the standards IS:13703 / IEC 60269.
- ▶ Available with ISI and CE marking.

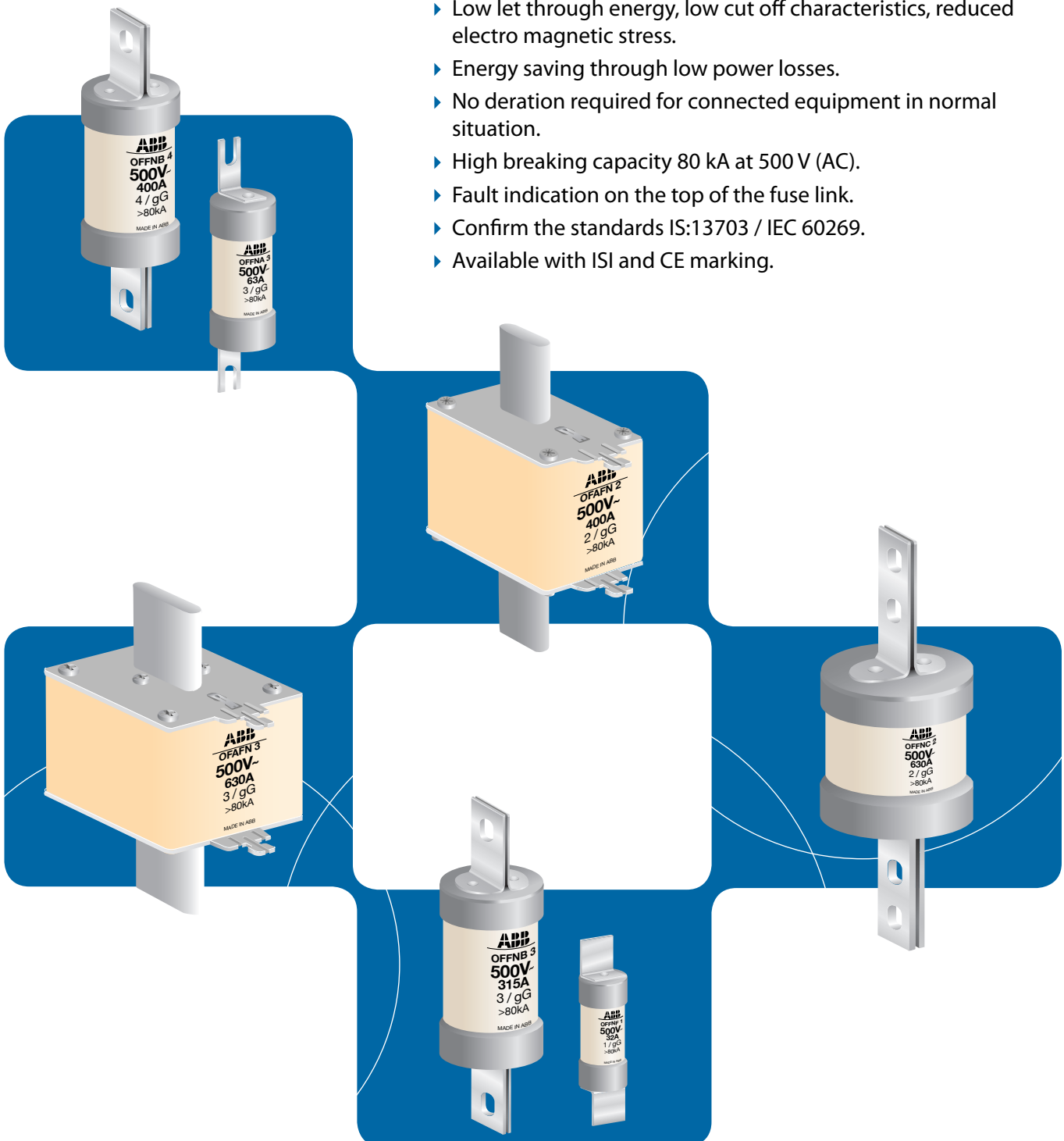



# HRC Fuse links, DIN-type

## Ordering information

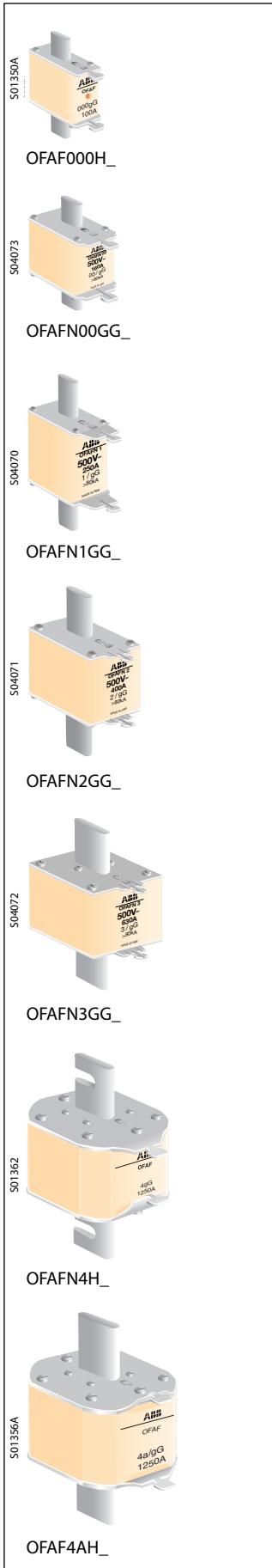

### DIN -type fuse links, gG, 500 V, 80 kA

The type code includes one fuse link, the delivery batch is according to the column.

IEC-size	In [A]	P <sub>n</sub> [W]	Type	Order number	Delivery batch [pcs]	Weight/unit [kg]
000	2	3.9	OFAF000H2	1SCA022627R0230	9	0.120
	6	1.6	OFAF000H6	1SCA022627R0400	9	0.120
	10	1.1	OFAF000H10	1SCA022627R0580	9	0.120
	16	1.8	OFAF000H16	1SCA022627R0660	9	0.120
	20	2.4	OFAF000H20	1SCA022627R0740	9	0.120
	32	2.7	OFAF000H32	1SCA022627R0910	9	0.120
	63	4.7	OFAF000H63	1SCA022627R1390	9	0.120
00	6	1.0	OFAFN00GG6	1SCA107754R1001	6	0.195
	10	1.4	OFAFN00GG10	1SCA107755R1001	6	0.195
	16	2.4	OFAFN00GG16	1SCA107756R1001	6	0.195
	20	2.5	OFAFN00GG20	1SCA107757R1001	6	0.195
	25	2.6	OFAFN00GG25	1SCA107758R1001	6	0.195
	32	4.2	OFAFN00GG32	1SCA107759R1001	6	0.195
	50	4.8	OFAFN00GG50	1SCA107760R1001	6	0.195
	63	6.1	OFAFN00GG63	1SCA107761R1001	6	0.195
	80	6.6	OFAFN00GG80	1SCA107762R1001	6	0.195
	100	7.3	OFAFN00GG100	1SCA107763R1001	6	0.195
	125	10.4	OFAFN00GG125	1SCA107764R1001	6	0.195
1	32	4.4	OFAFN1GG32	1SCA107766R1001	5	0.235
	50	6.3	OFAFN1GG50	1SCA107767R1001	5	0.425
	63	6.7	OFAFN1GG63	1SCA107768R1001	5	0.425
	80	8.0	OFAFN1GG80	1SCA107769R1001	5	0.425
	100	10.7	OFAFN1GG100	1SCA107770R1001	5	0.425
	125	13.4	OFAFN1GG125	1SCA107771R1001	5	0.425
	160	15.5	OFAFN1GG160	1SCA107772R1001	5	0.425
	200	20.0	OFAFN1GG200	1SCA107773R1001	3	0.425
	250	21.5	OFAFN1GG250	1SCA107774R1001	3	0.425
	2	100	10.0	OFAFN2GG100	1SCA107775R1001	3
125		12.0	OFAFN2GG125	1SCA107776R1001	3	0.585
250		22.0	OFAFN2GG250	1SCA107778R1001	3	0.585
315		25.0	OFAFN2GG315	1SCA107779R1001	3	0.585
400		30.0	OFAFN2GG400	1SCA107780R1001	3	0.585
3	315	22.0	OFAFN3GG315	1SCA107781R1001	3	0.975
	500	36.0	OFAFN3GG500	1SCA107783R1001	3	0.975
	630	39.0	OFAFN3GG630	1SCA107784R1001	3	0.975
	800		OFAFN3GG800	1SCA107785R1001	3	0.975
4	400	31.0	OFAF4H400	1SCA022627R7320	1	2.000
	500	35.0	OFAF4H500	1SCA022627R7410	1	2.000
	630	44.0	OFAF4H630	1SCA022627R7590	1	2.000
	800	70.0	OFAF4H800	1SCA022627R7670	1	2.000
	1000	85.0	OFAF4H1000	1SCA022627R7750	1	2.000
	1250	93.0	OFAF4H1250	1SCA022627R7830	1	2.000
4a	500	33.0	OFAF4AH500	1SCA022637R3980	1	2.000
	630	43.0	OFAF4AH630	1SCA022637R4010	1	2.000
	800	58.0	OFAF4AH800	1SCA022637R4100	1	2.000
	1000	71.0	OFAF4AH1000	1SCA022637R4280	1	2.000
	1250	85.0	OFAF4AH1250	1SCA022637R4360	1	2.000



# HRC Fuse links, BS-type

## Ordering information

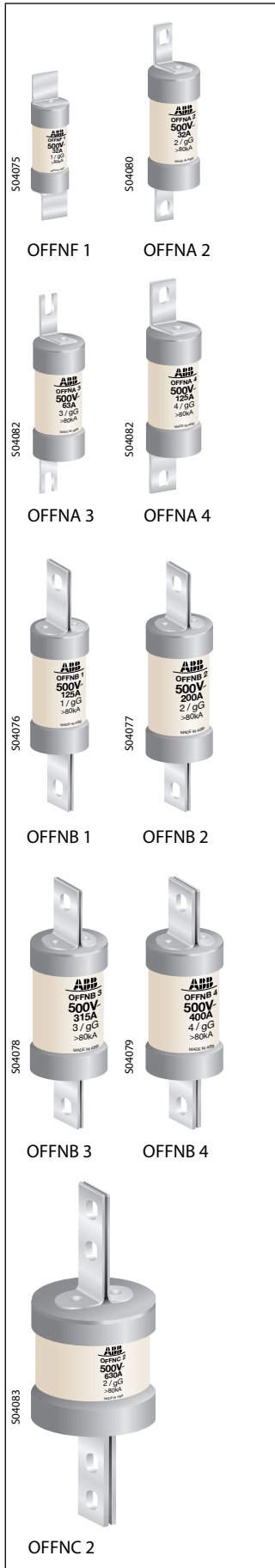

### BS -type fuse links, gG, 500 V, 80 kA

The type code includes one fuse link, but the delivery batch is according to the column.

BS-fuse type	In [A]	Ph [W]	Type	Order number	Delivery batch [pcs]	Weight/unit [kg]
<b>Tag type: Offset</b>						
F1	2	0.7	OFFNF1GG2	1SCA107786R1001	20	0.015
	4	0.7	OFFNF1GG4	1SCA107787R1001	20	0.015
	6	1.0	OFFNF1GG6	1SCA107788R1001	20	0.015
	10	1.1	OFFNF1GG10	1SCA107789R1001	20	0.015
	16	1.6	OFFNF1GG16	1SCA107790R1001	20	0.015
	20	1.9	OFFNF1GG20	1SCA107791R1001	20	0.015
	25	2.4	OFFNF1GG25	1SCA107792R1001	20	0.015
	32	2.7	OFFNF1GG32	1SCA107793R1001	20	0.015

### Tag type: Offset, two holes fixing 20

A2	6	1.4	OFFNA2GG6	1SCA107795R1001	10	0.050
	10	1.6	OFFNA2GG10	1SCA107796R1001	10	0.050
	16	2.5	OFFNA2GG16	1SCA107798R1001	10	0.050
	20	2.8	OFFNA2GG20	1SCA107827R1001	10	0.050
	25	2.8	OFFNA2GG25	1SCA107800R1001	10	0.050
A3	32	4.0	OFFNA2GG32	1SCA107801R1001	10	0.050
	35	5.0	OFFNA3GG35	1SCA107802R1001	10	0.055
	40	5.2	OFFNA3GG40	1SCA107803R1001	10	0.055
A4	50	5.5	OFFNA3GG50	1SCA107804R1001	10	0.055
	63	6.8	OFFNA3GG63	1SCA107805R1001	10	0.055
	50	6.0	OFFNA4GG50	1SCA107806R1001	10	0.145
	63	6.6	OFFNA4GG63	1SCA107807R1001	10	0.145
B1	80	7.9	OFFNA4GG80	1SCA107808R1001	10	0.145
	100	8.6	OFFNA4GG100	1SCA107809R1001	10	0.145
	125	12.0	OFFNA4GG125	1SCA107810R1001	10	0.145
	50	6.0	OFFNB1GG50	1SCA107811R1001	10	0.145
B2	63	6.7	OFFNB1GG63	1SCA107812R1001	10	0.145
	80	8.0	OFFNB1GG80	1SCA107813R1001	10	0.145
	100	8.6	OFFNB1GG100	1SCA107814R1001	10	0.145
	125	12.0	OFFNB1GG125	1SCA107815R1001	10	0.145
	125	13.5	OFFNB2GG125	1SCA107816R1001	3	0.230
	160	17.2	OFFNB2GG160	1SCA107817R1001	3	0.230
	200	20.4	OFFNB2GG200	1SCA107818R1001	3	0.230

### Tag type: Central, two holes fixing 10

B3	250	24.5	OFFNB3GG250	1SCA107819R1001	3	0.390
	315	28.5	OFFNB3GG315	1SCA107820R1001	3	0.390
B4	355	35.0	OFFNB4GG355	1SCA107821R1001	3	0.440
	400	37.0	OFFNB4GG400	1SCA107822R1001	3	0.440

### Tag type: Central, four holes fixing

C2	400	35.0	OFFNC2GG400	1SCA107823R1001	1	0.865
	500	40.0	OFFNC2GG500	1SCA107824R1001	1	0.865
	630	50.0	OFFNC2GG630	1SCA107825R1001	1	0.865
	800		OFFNC2GG800	1SCA107826R1001	1	



# HRC Fuse links, DIN-type Time-current characteristics

Time-current characteristics, OFAFN00-3gG\_ fuse links, type gG, 500 V

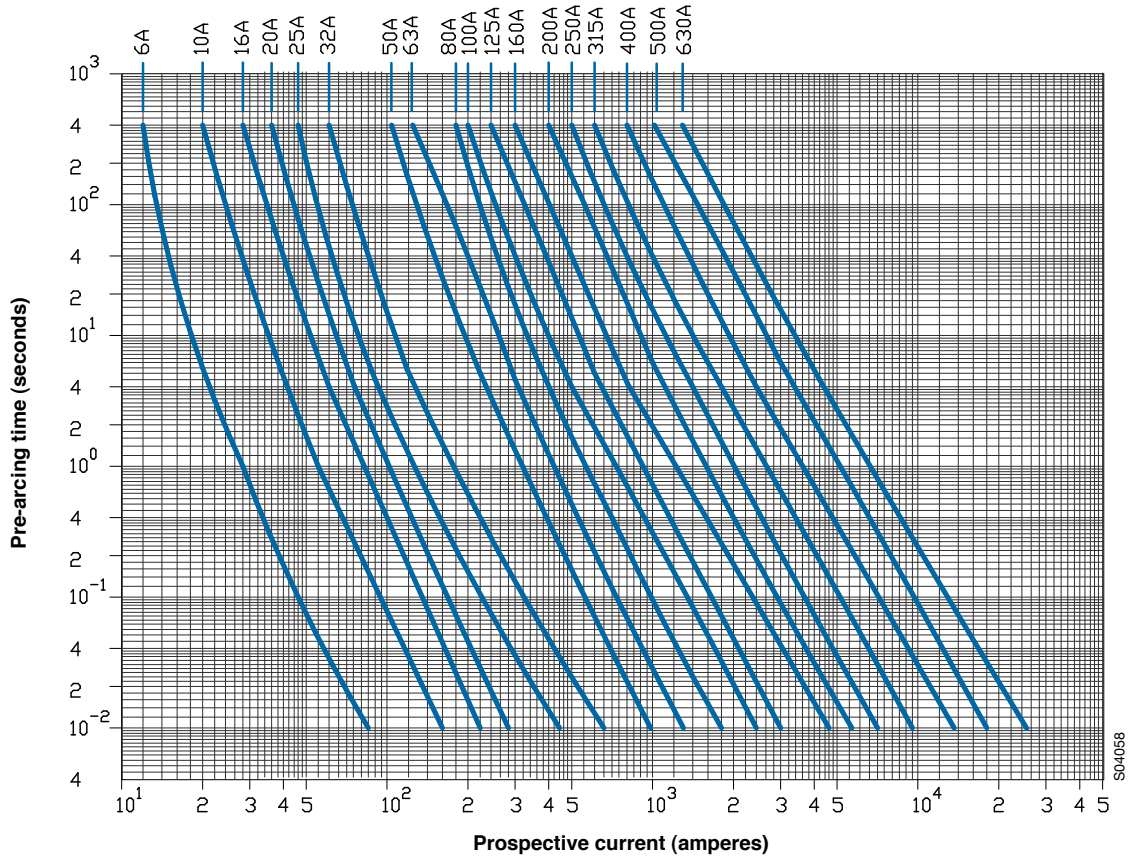

Time-current characteristics, OFAF000H\_ and OFAF4-4AH\_ fuse links, type gG, 500 V

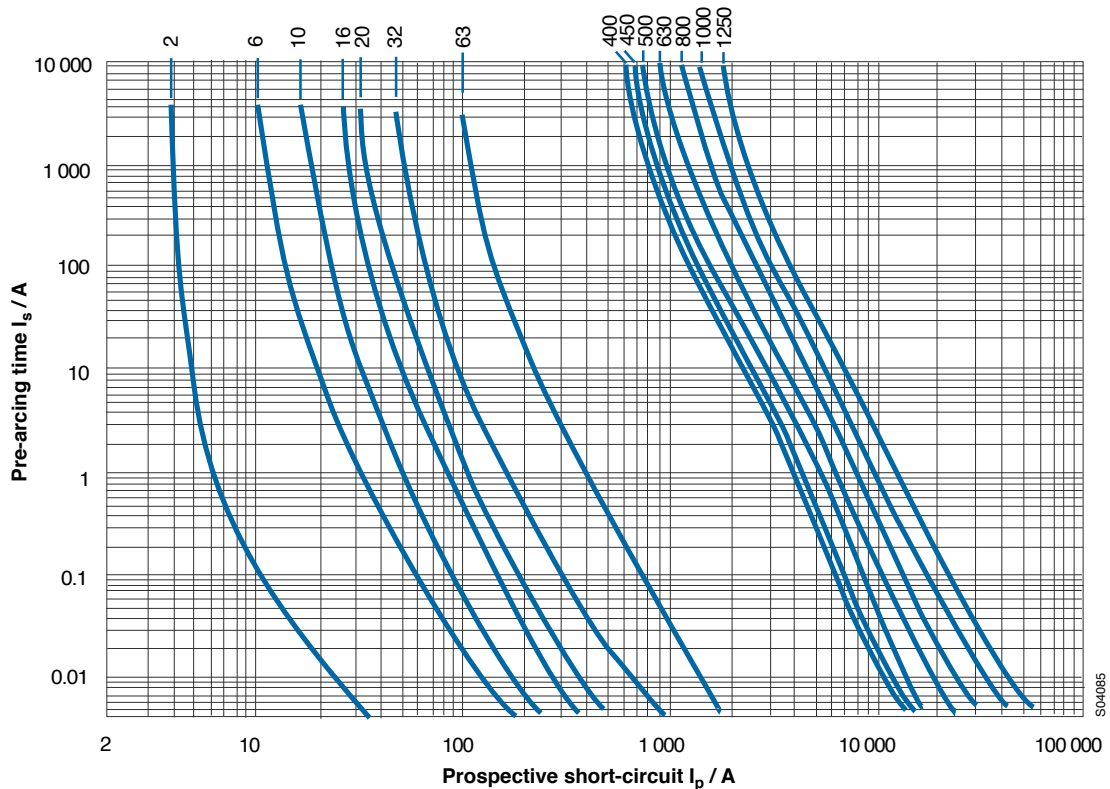



# HRC Fuse links, BS-type Time-current characteristics

Time-current characteristics, OFFN\_ fuse links, type gG, 500 V

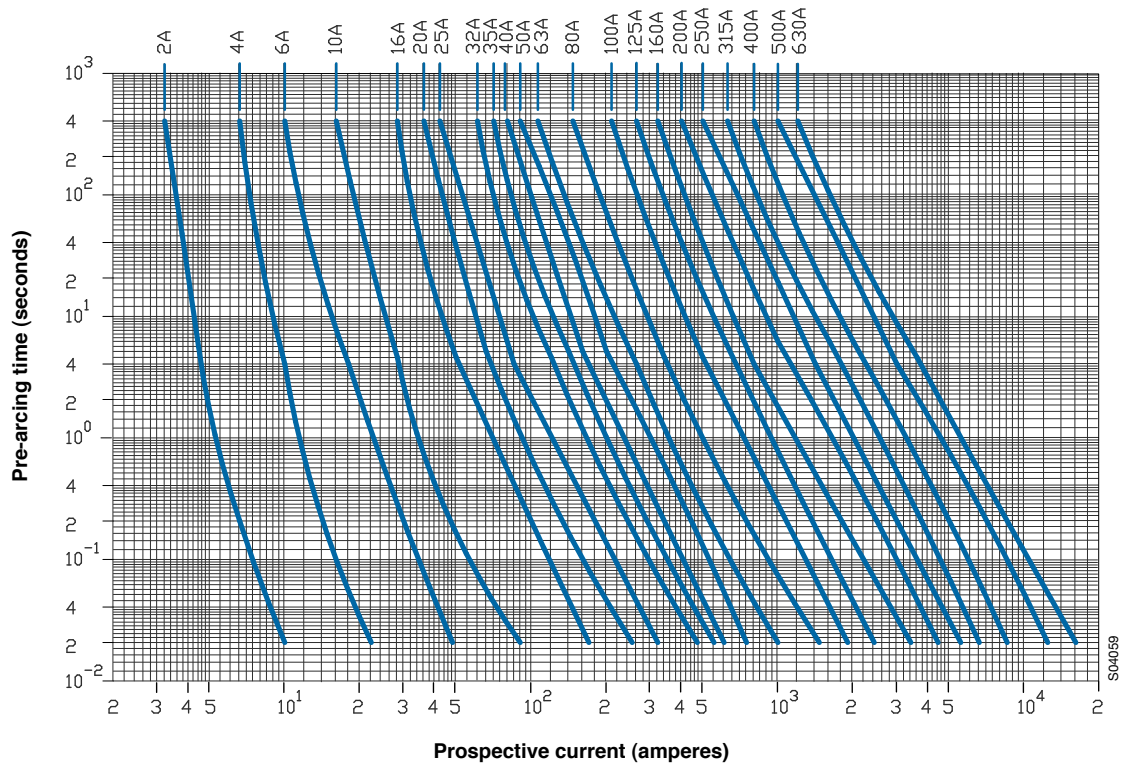



# HRC Fuse links Cut off -current characteristics

Current limitation, type OFAFN\_ and OFFN\_, type gG, 500 V

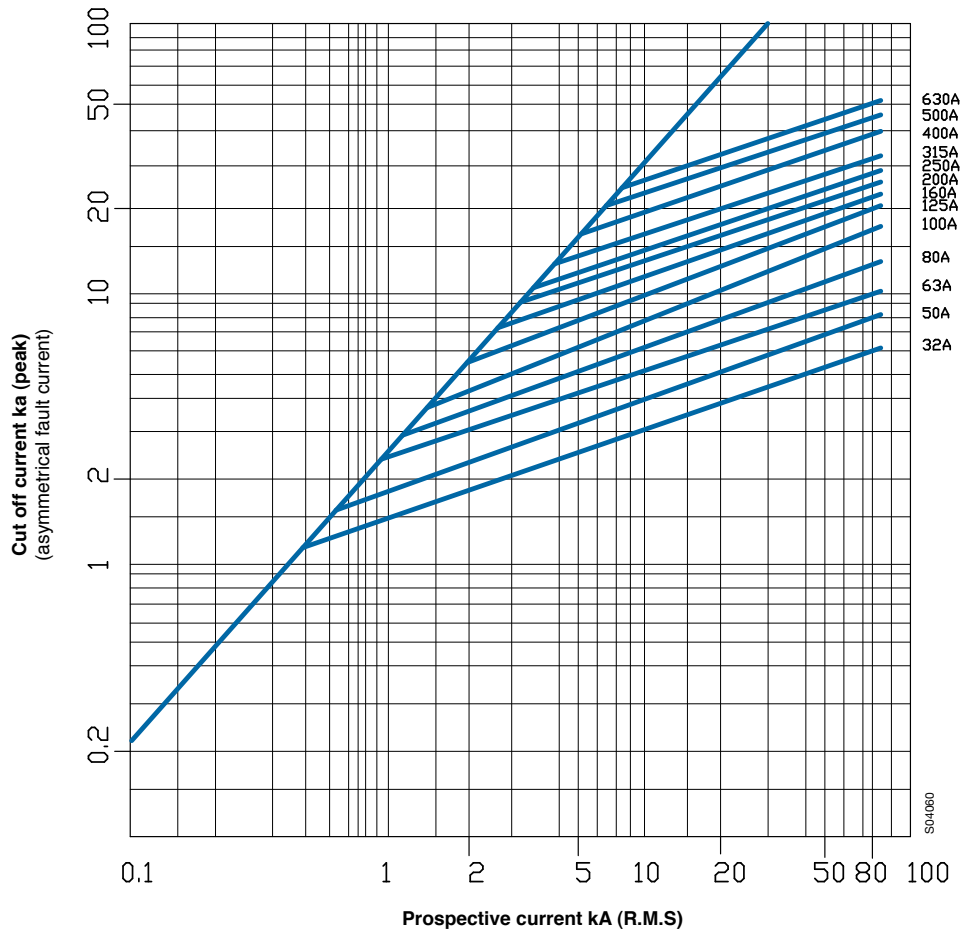

Current limitation, type OFAF000H\_ and OFAF4-4AH\_ fuse links, type gG, 500 V

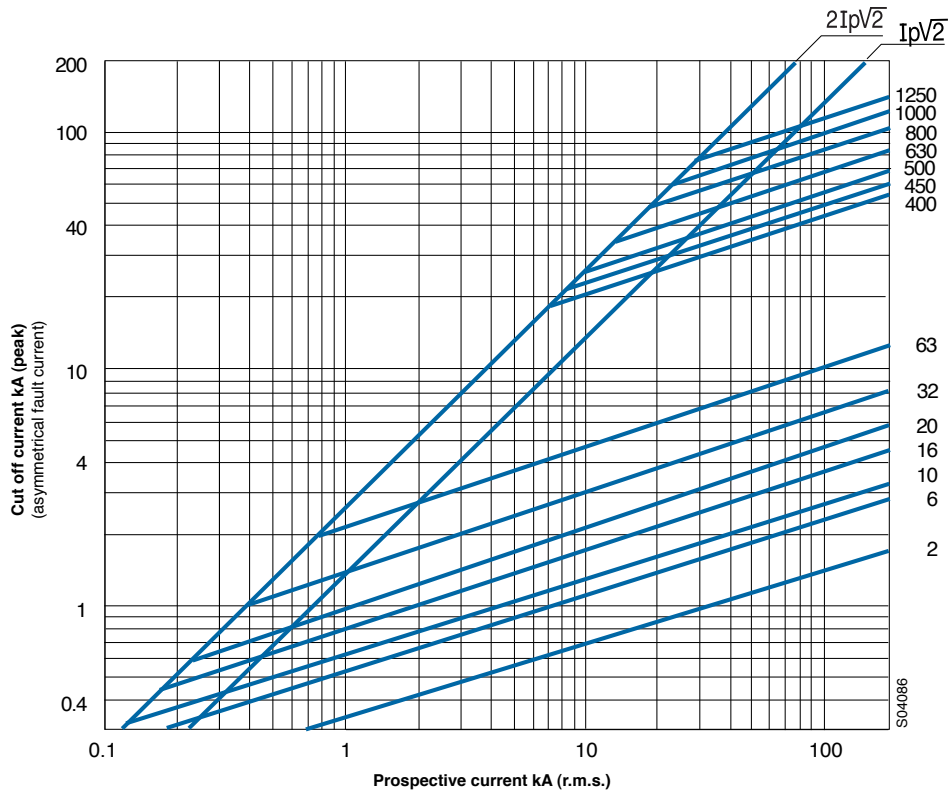



## HRC Fuse links $I^2t$ -values

$I^2t$  -values, DIN-type OFAFN\_ fuse links, type gG, 500 V

- with prospective current > 80 kA at 500 V

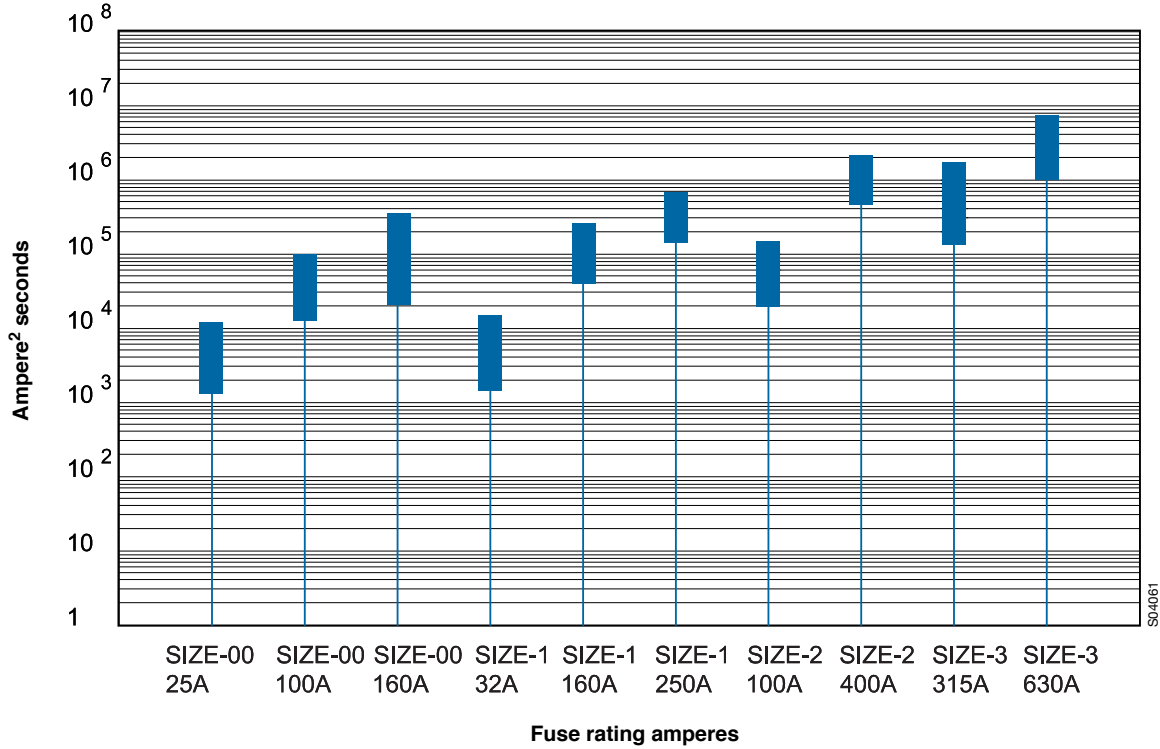

$I^2t$  -values, BS- type OFFN\_ fuse links, type gG, 500 V

- with prospective current > 80 kA at 500 V

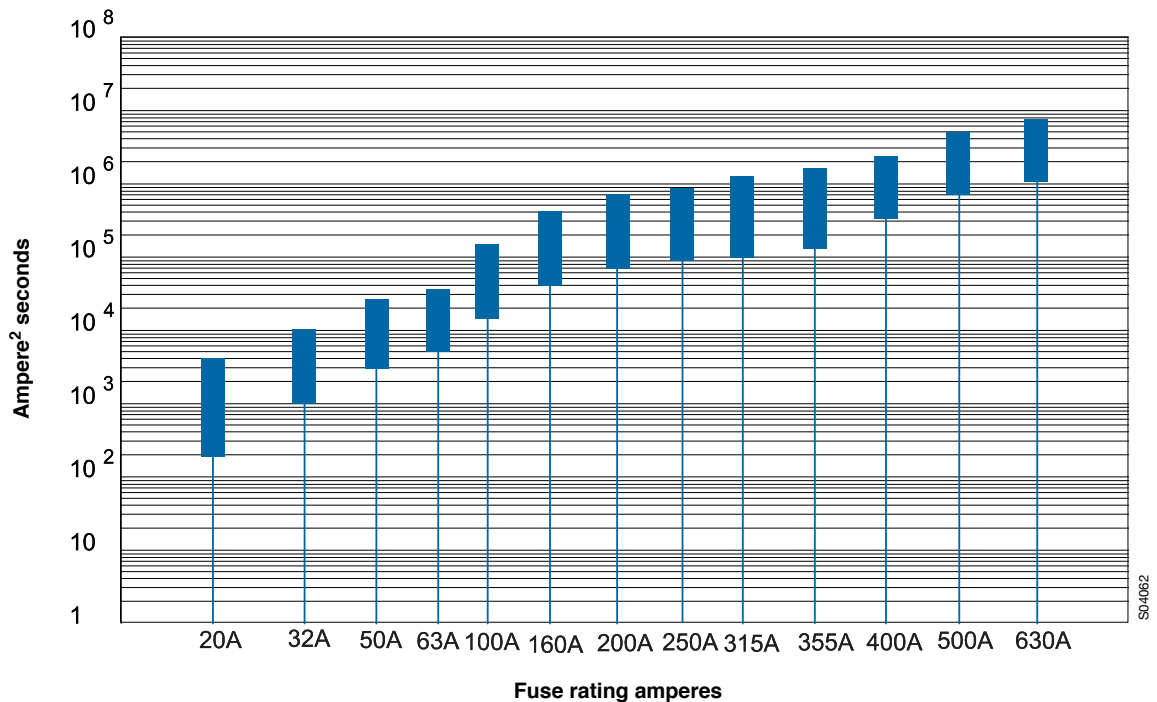



# HRC Fuse links Dimension drawings

## DIN-type OFAFN\_ and OFAF\_ fuse links

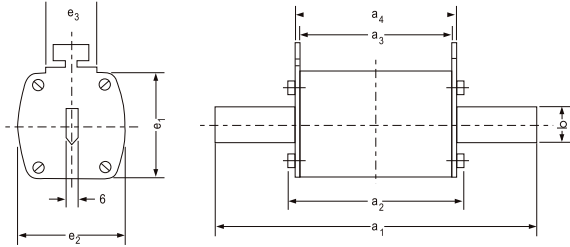

DIN-fuse size	Rated Current	a1	a2	a3	a4	b	e1	e2	e3
00	6-160A	78.5	51.5	45.5	49	15	43	30	20
1	32-160A	135	70	63	67	15	43	30	20
1	200-250A	135	70	63	67	20	48	46	22
2	100-250A	150	70	63	67	20	48	46	22
2	315-400A	150	72	60.5	67	33	57	56	25
3	315-630A	150	73	62	68.5	25	68	66	25

SO4063

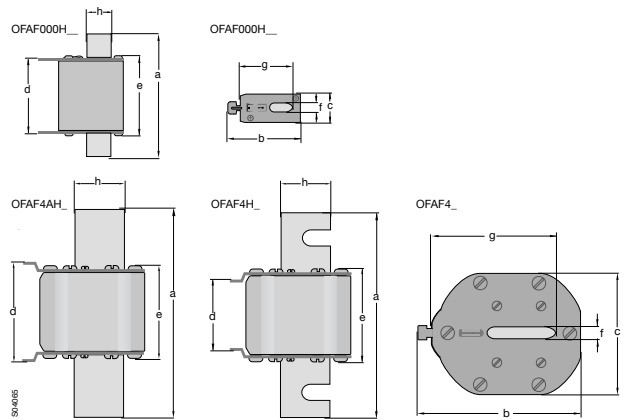

DIN Fuse size	a	b	c	d	e	f	g	h
000	79	52.5	20.8	49.5	52	6	35	15
4	200	119	89	88	85	8	85	49
4a	200	119	89	68	85	8	85	49

## BS- type OFFN\_ fuse links

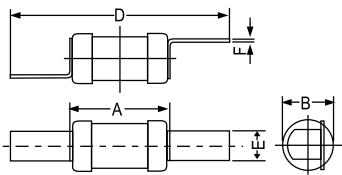

BS-Fuse size	A	B	C	E	F
F1	34	14.2	60	11	0.8

SO4064

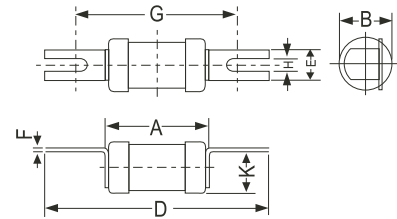

BS-Fuse size	A	B	D	E	F	G	H	K
A3	56	21.5	88.5	12.7	1.2	73	5.5	23

SO4066

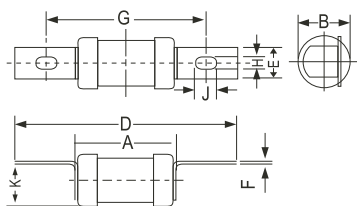

BS-Fuse size	A	B	D	E	F	G	H	J	K
A2	56	21.5	84.5	8.7	1.2	73	5.5	8	23
A4	64.5	31.8	110	17	2.65	94	8.7	10	33
-	73	39.5	110	19	2.35	94	8.7	11	42

SO4067

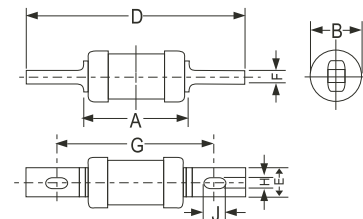

BS-Fuse size	A	B	D	E	F	G	H	J
B1	63.5	31.8	136	17	3.2	111	8.7	11
B2	72	39.5	132	19	3.2	111	8.7	11
B3	70	50.5	136	25.4	3.2	111	8.7	11
B4	72	50.5	136	25.4	5.3	111	8.7	11

SO4068

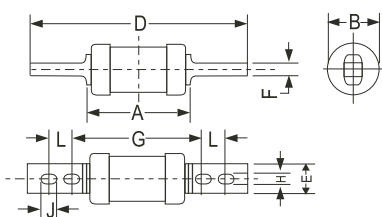

BS-Fuse size	A	B	D	E	F	G	H	J
C2	71	70	208	25.4	6.5	133	10.3	12.5

SO4069



**ABB Limited**

Plot Nos 5&6, 2nd Phase,  
Peenya Industrial Area,  
Bangalore 560058, India.  
Telephone +91 80 2294 9340  
Telefax +91 80 2294 9547  
[www.abb.com](http://www.abb.com)

The technical data and dimensions are valid at the time of printing.  
We reserve the right to subsequent alterations.

Catalogue OF3GB\_IN08\_08  
1SCC317005C0201

Produced by: KATANN Document Factory Oy, Vaasa Finland