

# A9K

MCB, RCCB, Isolator



**Schneider**  
Electric™

# Schneider Electric - The global specialist in energy management and automation





brings **180 years of experience** to India with more than **170,000 people** in over a **100 countries**



<p>We Reduce energy consumed and create reliable safe efficient and sustainable industrial ecosystems</p>	<p>We Reduce cost per kWh and create significant energy cost savings for your home, office, industry with our energy efficient products &amp; solutions</p>	<p>We Reduce CO<sub>2</sub> footprints and create great environments in which we live work and play</p>	<p>We Reduce operating expenditures by at least 30% in an industrial world where energy is one of the top five largest operating budget line items</p>	<p>We Realise measurable efficiency and deliver solutions that integrate seamlessly into our environment</p>	<p>We Produce energy locally across the grid allowing India to reshape industries, transform cities and enrich lives</p>
---	---	---	--	--	--

Our vision is to help customers achieve more with less resources in an increasingly connected, distributed, and smart world

## Schneider Electric India footprint - A top 3 energy management company in India

 <p>Employee strength</p>	<p>21,000+ People</p>	 <p>Industrial footprint</p>	<p>29 Factories</p>
 <p>R&amp;D focus</p>	<p>1,500+ R&amp;D Staff (based in India)</p>	 <p>Channel strength</p>	<p>60,000+ Point of sales 2,200+ Distributors</p>



IS/IEC 60898-1

IEC/EN 60898-1



b K60H Biconnect circuit breakers are circuit breakers which combine the following functions:

- v circuit protection against short-circuit currents,
- v circuit protection against overload currents,
- v disconnection, opening and closing.

### K60H Biconnect Miniature Circuit Breaker 50Hz

Breaking capacity in short circuit (I <sub>cn</sub> ) as per IEC/EN 60898-1		Service breaking capacity (I <sub>cs</sub> )
Ph/Ph	415 V	
Ph/N	240 V	
Rating (I <sub>n</sub> )	1 to 63 A	10000 A

## Catalogue numbers

K60H Biconnect Miniature Circuit Breaker						
Type	1P		2P		3P	4P
Auxiliaries	Without auxiliaries					
Rating (I <sub>n</sub> )	Curve		Curve		Curve	Curve
	B	C	B	C	C	C
1 A	-	A9KF71101	-	A9KF71201	A9KF71301	A9KF71401
2 A	-	A9KF71102	-	A9KF71202	A9KF71302	A9KF71402
3 A	-	A9KF71103	-	A9KF71203	A9KF71303	A9KF71403
4 A	-	A9KF71104	-	A9KF71204	A9KF71304	A9KF71404
6 A	A9KF21106	A9KF71106	A9KF21206	A9KF71206	A9KF71306	A9KF71406
10 A	A9KF21110	A9KF71110	A9KF21210	A9KF71210	A9KF71310	A9KF71410
16 A	A9KF21116	A9KF71116	A9KF21216	A9KF71216	A9KF71316	A9KF71416
20 A	A9KF21120	A9KF71120	A9KF21220	A9KF71220	A9KF71320	A9KF71420
25 A	A9KF21125	A9KF71125	A9KF21225	A9KF71225	A9KF71325	A9KF71425
32 A	A9KF21132	A9KF71132	A9KF21232	A9KF71232	A9KF71332	A9KF71432
40 A	-	A9KF71140	-	A9KF71240	A9KF71340	A9KF71440
50 A	-	A9KF71150	-	A9KF71250	A9KF71350	A9KF71450
63 A	-	A9KF71163	-	A9KF71263	A9KF71363	A9KF71463
Width in 9-mm modules	2		4		6	8
Accessories	Padlocking device cat. no. 26970					

### Ordering Information:

Add suffix <BQ> to the Product Reference to get the corresponding Ordering Code  
 Contact Schneider Electric Sales Representative or Customer Care Centre to get information on prices and standard pack sizes

# K60H Biconnect Miniature Circuit Breakers (contd.)

## Connection

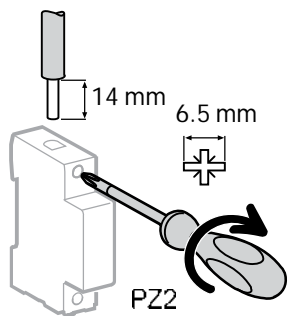

Type	Rating	Tightening torque	Copper cables	
			Rigid	Flexible or with ferrule
K60H Biconnect	1 to 32 A	2 N.m	1 to 25 mm <sup>2</sup>	1 to 16 mm <sup>2</sup>
	40 to 63 A	3.5 N.m	1 to 35 mm <sup>2</sup>	1 to 25 mm <sup>2</sup>

## Technical data

Main characteristics			
Insulation voltage (Ui)	Phase-to-phase	500 V AC	
	Phase-to-neutral	240 V AC	
Voltage rating (Ue)	Phase-to-phase	415 V AC	
		50 Hz	
Operating Frequency	50 Hz		
Rated impulse withstand voltage (Uimp)	4 kV		
Magnetic tripping	B curve	3 to 5 In	b
	C curve	5 to 10 In	b

According to EN 60898-1	
Limitation class	3
Rated breaking capacity (Icn)	10,000 A
Service breaking capacity (Ics)	75 % Icn
Rated breaking and making capacity on a single pole (Icn1)	Icn1 = Icn

Additional characteristics			
Degree of protection (IEC 60529)	Device only	IP20	
	Device in modular enclosure	IP40 Insulation class II	
Line-Load Reversibility	Yes		
Endurance (O-C)	Electrical	y 20 A	20,000 cycles
		u 25 A	10,000 cycles
	Mechanical	20,000 cycles	
Operating temperature	-5 °C to +55 °C		

## Dimensions (mm)

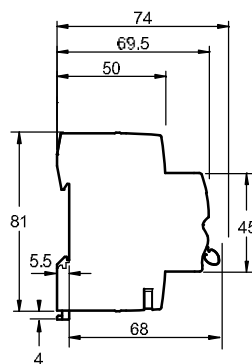
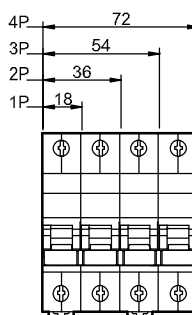

## Weight (g)

Circuit-breaker	
Type	K60H Biconnect
1P	120
2P	240
3P	360
4P	480



IS 12640 (Part 1) IEC/EN 61008-1



- b The ID K Biconnect residual current circuit breakers offer the following functions:
- ✓ protection of persons against electric shock by direct contact (30 mA),
  - ✓ protection of persons against electric shock by indirect contact (I<sub>n</sub> 100 mA),
  - ✓ protection of installations against the risks of fire (300 mA).

**Catalogue numbers**

**ID K Biconnect Residual Current Circuit Breakers**

Type	AC	Width in 9 mm modules			
<b>2P</b>	<b>Sensitivity</b>	<b>30 mA</b>	<b>100 mA</b>	<b>300 mA</b>	
	25 A	A9KR11225	A9KR12225	A9KR14225	
	40 A	A9KR11240	A9KR12240	A9KR14240	
	63 A	A9KR11263	A9KR12263	A9KR14263	
<b>4P</b>	<b>Sensitivity</b>				
	<b>Rating</b>	25 A	A9KR11425	A9KR12425	A9KR14425
	40 A	A9KR11440	A9KR12440	A9KR14440	
	63 A	A9KR11463	A9KR12463	A9KR14463	
Operating voltage (U <sub>e</sub> )	2P	240 V			
	4P	415 V			
Operating frequency	50 Hz				

**Note:**

- 1** Use of 30mA RCCBs is now mandatory for all domestic applications (CEA Amendment regulation 2015\*)
- 2** Use of minimum 100mA RCCBs is now mandatory for all installations (CEA Amendment regulation 2015\*)
- 3** Voltage Independent RCCBs for complete protection - Schneider Electric RCCBs work on current sensing technology and provide protection even at extra low voltages (down to zero volts) and in case of break of neutral.

**Connection**

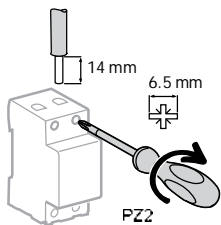

Type	Tightening torque	Copper cables	
		Rigid	Flexible or with ferrule
ID K Biconnect	3.5 N.m	1 to 35 mm <sup>2</sup>	1 to 25 mm <sup>2</sup>

**Technical data**

Main characteristics		
Insulation voltage (U <sub>i</sub> )	440 V	
Rated impulse withstand voltage (U <sub>imp</sub> )	4 kV	
Conditional rated short-circuit current (I <sub>nc</sub> /Δc) With circuit breaker	6000 A	
Behaviour in case of voltage drop	Residual current protection down to 0 V according to IEC/EN 61008-1 § 3.3.4	
Additional characteristics		
Degree of protection	Device only	IP20
	Device in a modular enclosure	IP40 Insulation class II
Operating temperature	AC type	-5 °C to +55 °C

**Dimensions (mm)**

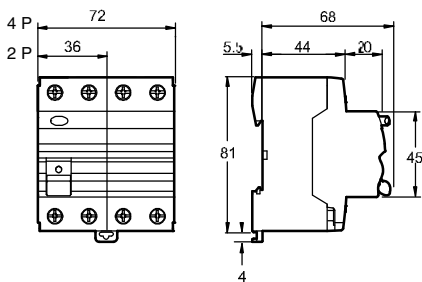

**Weight (g)**

Residual current circuit breakers	
Type	ID K Biconnect
2P	180
4P	350

**Ordering Information:**

Add suffix <BQ> to the Product Reference to get the corresponding Ordering Code  
 Contact Schneider Electric Sales Representative or Customer Care Centre to get information on prices and standard pack sizes

\* For Measures relating to Safety and Electric supply







## IS/IEC 60947-3

Control and disconnection of on-load electrical circuits already protected against overloads and short-circuits.

## Catalogue numbers

## SW Biconnect Switch-Disconnectors

Type				Width in 9 mm modules
<b>1P</b>	<b>Rating (In)</b>	<b>Voltage (Ue)</b>		
	40 A	240 V AC	A9KS15140	2
	63 A	240 V AC	A9KS15163	
<b>2P</b>				
	40 A	415 V AC	A9KS15240	4
	63 A	415 V AC	A9KS15263	
	80 A	415 V AC	A9KS15280	
<b>3P</b>				
	40 A	415 V AC	A9KS15340	6
	63 A	415 V AC	A9KS15363	
<b>4P</b>				
	40 A	415 V AC	A9KS15440	8
	63 A	415 V AC	A9KS15463	
	80 A	415 V AC	A9KS15480	
Operating frequency			50 Hz	

## Technical data

## Main characteristics

Insulation voltage (Ui)	500 V AC	
<b>Power circuit</b>		
Rated impulse withstand voltage (Uimp)	4 kV	
Operating category	AC-22 A	
Permissible rated short-time withstand current (Icw)	12 In for 300 ms	
Rated short-circuit closing current (Icm)	40 - 63 A	15 In
	80 A	1 kA

## Additional characteristics

Degree of protection	Device only	IP20
	Device in modular enclosure	IP40
Endurance (O-C)	Mechanical	20,000 cycles
	Electrical	10,000 cycles
Operating temperature	-5 °C to +55 °C	

## Weight (g)

## Biconnect switch-disconnectors

Type	SW Biconnect
1P	120
2P	240
3P	360
3P	480

## Dimensions (mm)

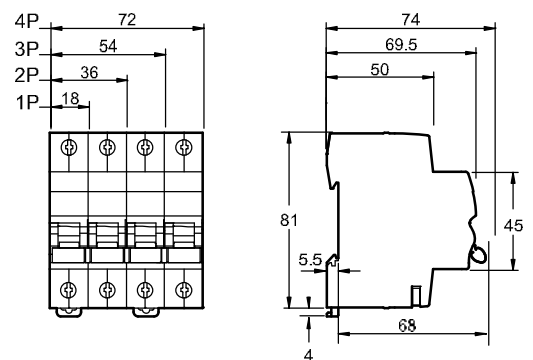

## Ordering Information:

Add suffix <BQ> to the Product Reference to get the corresponding Ordering Code  
Contact Schneider Electric Sales Representative or Customer Care Centre to get information on prices and standard pack sizes

## Ordering Reference Selection Guide

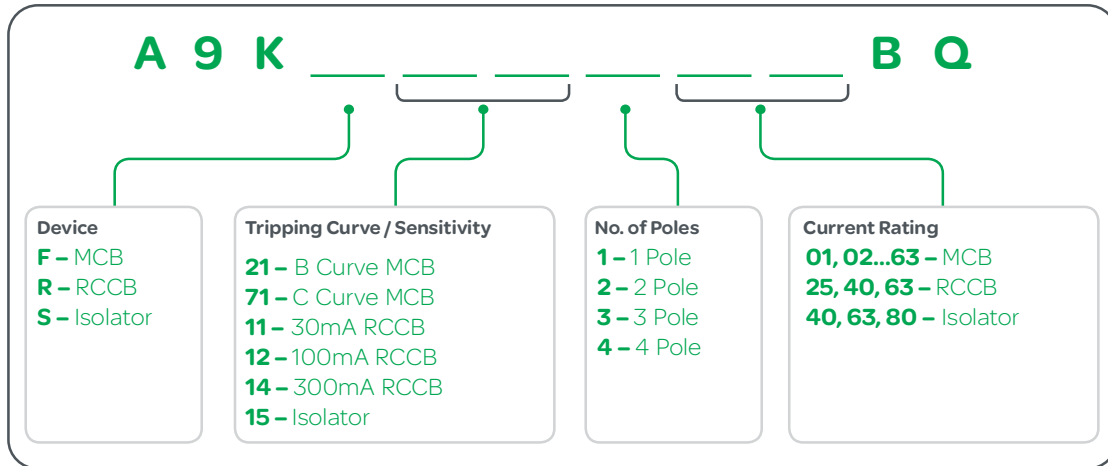

## How to Reach Team@ CCC ?



Customers

**BOARD LINES**

**TOLL FREE**

**E-MAIL**



Board Lines -  
+91-172-3324500 (Mohali)  
+91-80-43333333 (Bangalore)



CCC Toll Free Numbers:  
1800425 4272, 1800103 0011



in.campaign@schneider-electric.com

Open: Monday to Saturday 9:00 AM to 8:00 PM



Your fastest path to answers

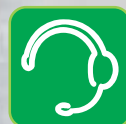

Try the Customer Care by Schneider Electric app, today!



### 24/7 access to self-service support

Get free, immediate access to continuously updated technical content such as FAQs, product documentation (via search or QR code scan), product registration, services, technical courses...

### Contact a local customer support expert

Connect to expertise on demand or request assistance with direct call and new case creation via the app.

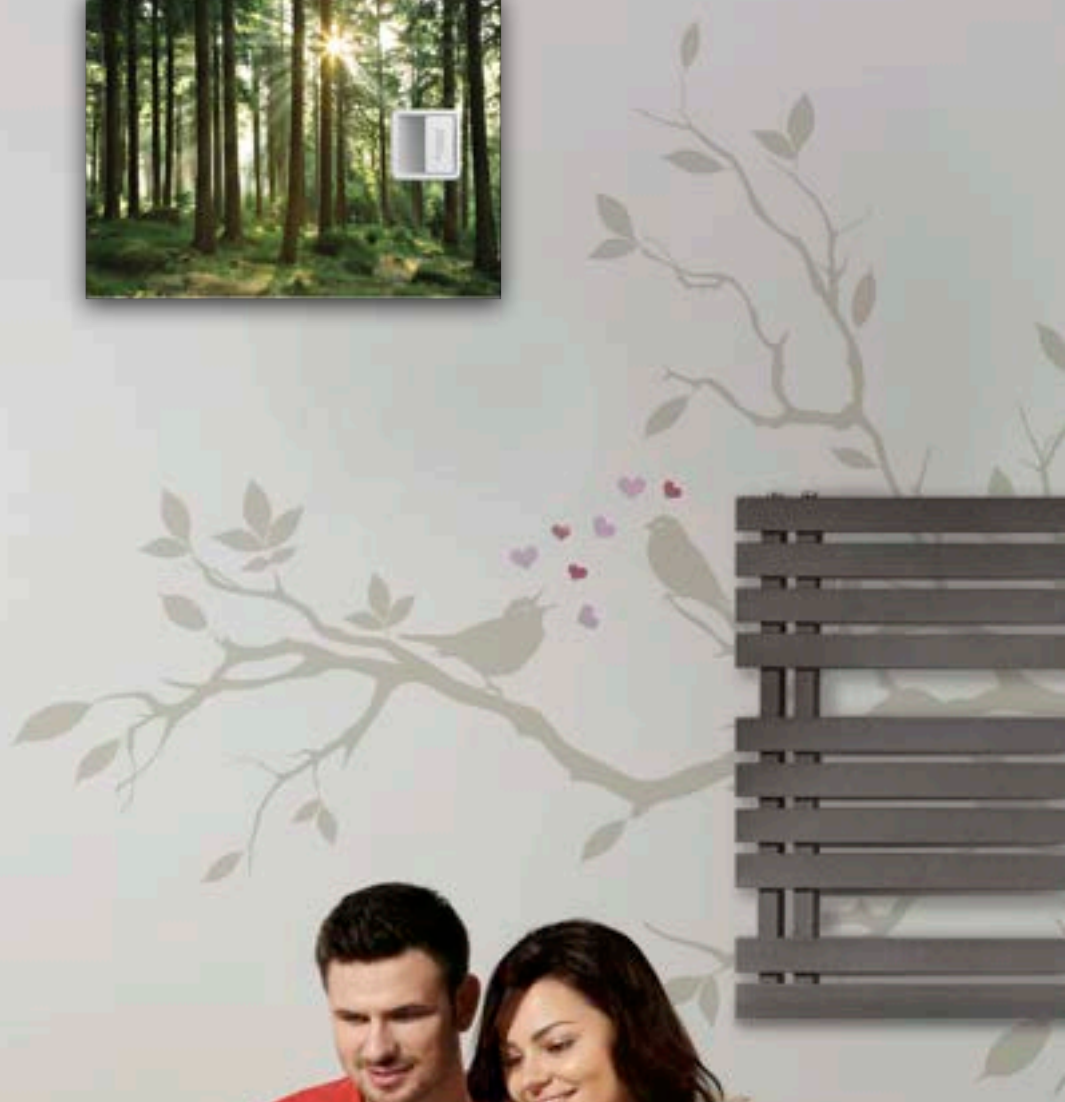

# Protection Devices



## Miniature Circuit Breaker (MCB)

- ISI/CE marked as per IS/IEC 60898-1
- 10 kA breaking capacity
- B and C tripping curves
- 1 Pole to 4 Pole
- 6 to 63 A current rating
- Suitable for positive isolation
- Operating voltage 240 V/415 V
- Frequency 50 Hz



### Easy9 Biconnect MCB India Offer

Breaking Capacity 10000 A

Type	1P	2P	3P	4P
Auxiliaries	Without auxiliaries			
Rating (In)	Curve	Curve	Curve	Curve
	B	C	B	C
1 A	-	EZ9F71101	-	EZ9F71201
2 A	-	EZ9F71102	-	EZ9F71202
3 A	-	EZ9F71103	-	EZ9F71203
4 A	-	EZ9F71104	-	EZ9F71204
6 A	EZ9F21106	EZ9F71106	EZ9F21206	EZ9F71206
10 A	EZ9F21110	EZ9F71110	EZ9F21210	EZ9F71210
16 A	EZ9F21116	EZ9F71116	EZ9F21216	EZ9F71216
20 A	EZ9F21120	EZ9F71120	EZ9F21220	EZ9F71220
25 A	EZ9F21125	EZ9F71125	EZ9F21225	EZ9F71225
32 A	EZ9F21132	EZ9F71132	EZ9F21232	EZ9F71232
40 A	EZ9F21140	EZ9F71140	EZ9F21240	EZ9F71240
50 A	EZ9F21150	EZ9F71150	EZ9F21250	EZ9F71250
63 A	EZ9F21163	EZ9F71163	EZ9F21263	EZ9F71263

Breaking Capacity 6000 A

Type	1P	2P	3P	4P
Auxiliaries	Without auxiliaries			
Rating (In)	Curve	Curve	Curve	Curve
	C	C	C	C
6 A	EZ9F76106	EZ9F76206	EZ9F76306	EZ9F76406
10 A	EZ9F76110	EZ9F76210	EZ9F76310	EZ9F76410
16 A	EZ9F76116	EZ9F76216	EZ9F76316	EZ9F76416
20 A	EZ9F76120	EZ9F76220	EZ9F76320	EZ9F76420
25 A	EZ9F76125	EZ9F76225	EZ9F76325	EZ9F76425
32 A	EZ9F76132	EZ9F76232	EZ9F76332	EZ9F76432
40 A	EZ9F76140	EZ9F76240	EZ9F76340	EZ9F76440

## Residual Current Circuit Breaker (RCCB)

- ISI/CE marked as per IS/IEC 61008-1
- 2 Pole and 4 Pole
- 25 A, 40 A, and 63 A current rating
- 30 mA, 100 mA, and 300 mA sensitivity
- Suitable for positive isolation
- Operating voltage 240 V/415 V
- Frequency 50 Hz



Easy9 Biconnect RCCB India Offer					
Type	AC~				Width in 18 mm modules
	Sensitivity	30 mA	100 mA	300 mA	
2P					2
	Rating				
	25 A	EZ9R35225	EZ9R55225	EZ9R65225	
	40 A	EZ9R35240	EZ9R55240	EZ9R65240	
	63 A	EZ9R35263	EZ9R55263	EZ9R65263	
4P					4
	Rating				
	25 A	EZ9R35425	EZ9R55425	EZ9R65425	
	40 A	EZ9R35440	EZ9R55440	EZ9R65440	
	63 A	EZ9R35463	EZ9R55463	EZ9R65463	

## Isolator

- CE marked, AC-22 A, conforms to IEC 60947-3
- 2 Pole, 3 Pole, and 4 Pole
- 40 A, 63 A, and 80 A\* current rating
- Suitable for positive isolation
- Operating voltage 240 V/415 V
- Frequency 50 Hz



Easy9 Biconnect Isolator India Offer				
Type	AC~			Width in 18 mm modules
	Rating (In)	Voltage (Ue)		
1P				1
	40 A	240 V	EZ9S66140	
	63 A	240 V	EZ9S66163	
2P				2
	40 A	415 V	EZ9S66240	
	63 A	415 V	EZ9S66263	
	80 A	415 V	EZ9S66280	
3P				3
	40 A	415 V	EZ9S66340	
	63 A	415 V	EZ9S66363	
4P				4
	40 A	415 V	EZ9S66440	
	63 A	415 V	EZ9S66463	
	80 A	415 V	EZ9S66480	



# Dimension Details

## SPN

### Distribution Boards

Commercial Reference	A	B	C
EZ9ESNS04	172	182	96
EZ9ESNS06	208	218	132
EZ9ESNS08	244	254	168
EZ9ESNS12	316	326	240
EZ9ESND04	172	221	96
EZ9ESND06	208	257	132
EZ9ESND08	244	293	168
EZ9ESND10	280	329	220
EZ9ESND12	316	365	240
EZ9ESND16	388	437	292

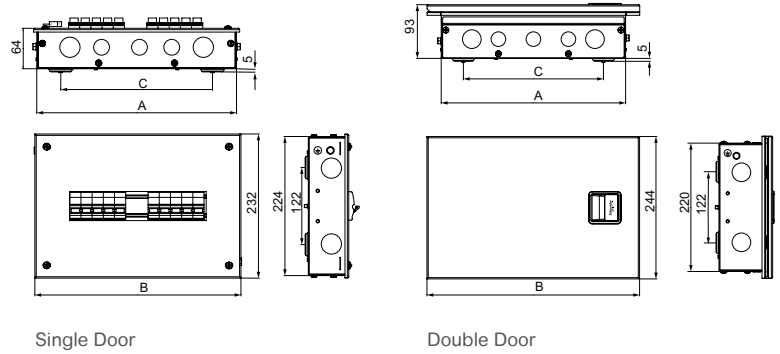

## TPN

### Distribution Boards

Commercial Reference	A	B	C
EZ9ETNS04	351	361	226
EZ9ETNS06	387	397	262
EZ9ETNS08	423	433	298
EZ9ETND04E	279	328	154
EZ9ETND04	351	400	226
EZ9ETND06	387	435	262
EZ9ETND08	423	471	298
EZ9ETND12	577	625	452

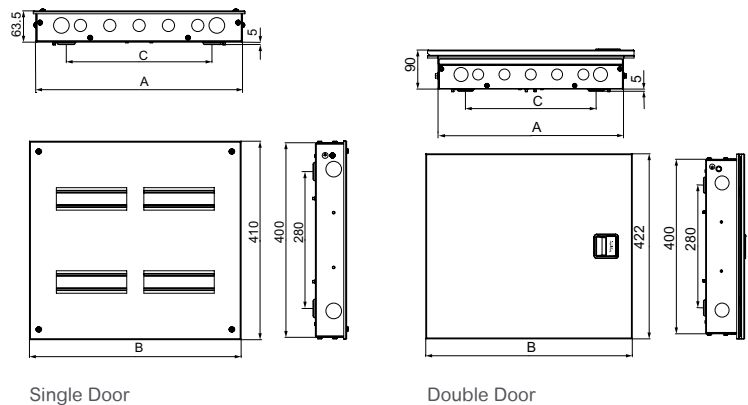

## VTPN

### Distribution Boards

Commercial Reference	A	B	C
EZ9EVTD04	495	518	376
EZ9EVTD08	602	625	483
EZ9EVTD12	709	731	589

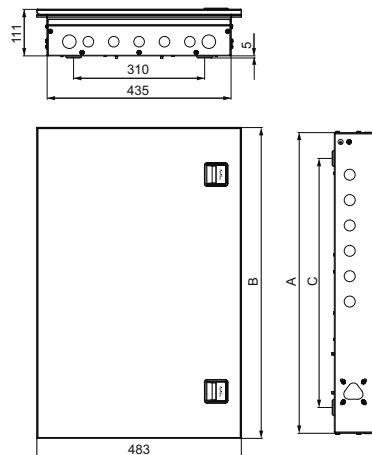

## Phase Selector

Distribution Boards			
Commercial Reference	A	B	C
EZ9EPVD04	-	-	-
EZ9EPVD06	-	-	-
EZ9EPVD08	-	-	-
EZ9EPHD04	503	551	378
EZ9EPHD06	539	587	414
EZ9EPHD08	575	623	450

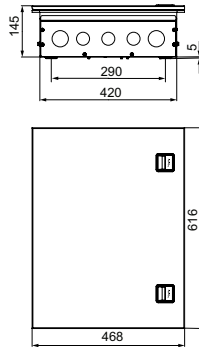

Vertical Phase Selector

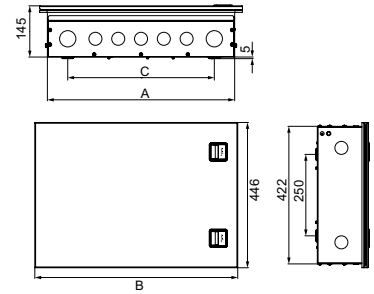

Horizontal Phase Selector

## Metal Enclosures

Enclosures	
Commercial Reference	No. of Modules
EZ9EMES02	2
EZ9EMES04	4

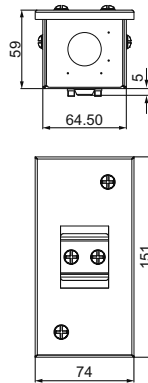

2 Module

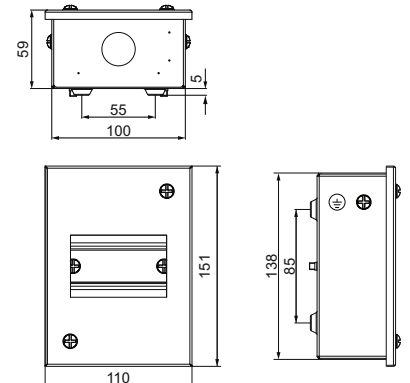

4 Module

## Plug and Socket Units

P and S Units	
Commercial Reference	No. of Modules
EZ9EMS210	2
EZ9EMS220	2
EZ9EMS320	3
EZ9EMS330	3

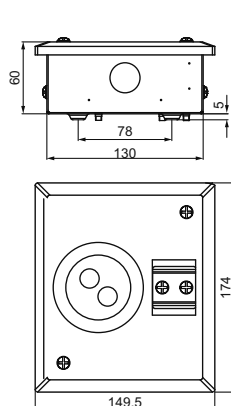

2 Module

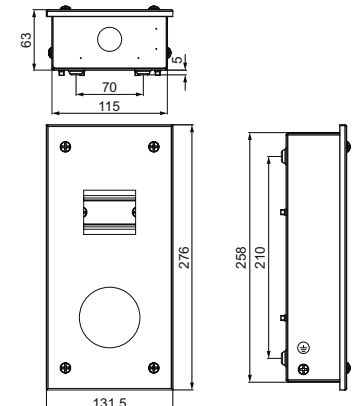

3 Module

## Selector Switches

Selector switches	
Commercial Reference	Description
EZ9EPS40S	EZ9 DB 40A pre-assembled selector switch
EZ9EPS63S	EZ9 DB 63A pre-assembled selector switch

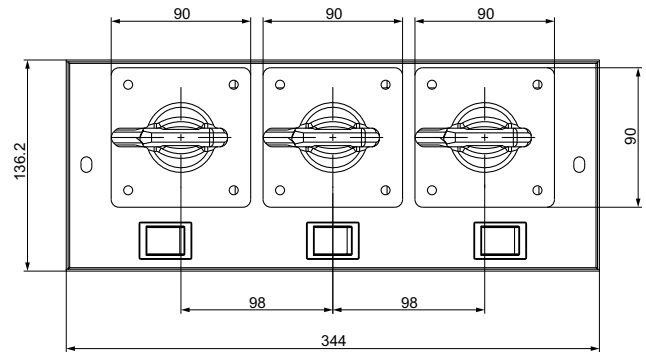

## Miniature Circuit Breakers

Weight (g)	
Type	Easy9 Biconnect
1P	120
2P	240
3P	360
4P	480

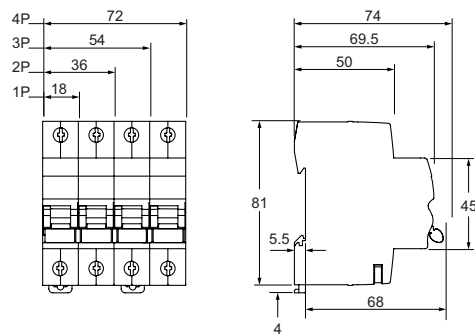

## Residual Current Circuit Breakers

Weight (g)	
Type	Easy9 Biconnect
2P	180
4P	350

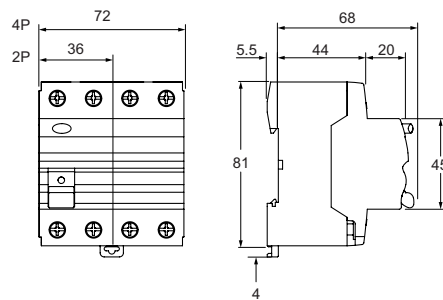

## Isolator

Weight (g)	
Type	Easy9 Biconnect
1P	120
2P	240
3P	360
4P	480

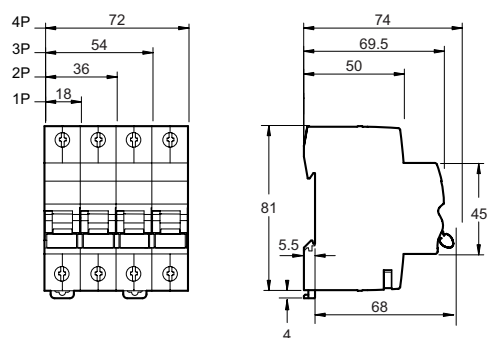



# Green Premium™

Endorsing eco-friendly products in the industry



## Green Premium™ Product

Green Premium is the only label that allows you to effectively develop and promote an environmental policy whilst preserving your business efficiency. This ecolabel guarantees compliance with up-to-date environmental regulations, but it does more than this.

Over 75 % of Schneider Electric manufactured products have been awarded the Green Premium ecolabel



Discover what we mean by green ....

**Check your products!**

Schneider Electric's Green Premium ecolabel is committed to offering transparency, by disclosing extensive and reliable information related to the environmental impact of its products:

### RoHS

Schneider Electric products are subject to RoHS requirements at a worldwide level, even for the many products that are not required to comply with the terms of the regulation. Compliance certificates are available for products that fulfil the criteria of this European initiative, which aims to eliminate hazardous substances.

### REACH

Schneider Electric applies the strict REACH regulation on its products at a worldwide level, and discloses extensive information concerning the presence of SVHC (Substances of Very High Concern) in all of these products.

### PEP: Product Environmental Profile

Schneider Electric publishes complete set of environmental data, including carbon footprint and energy consumption data for each of the lifecycle phases on all of its products, in compliance with the ISO 14025 PEP ecopassport program. PEP is especially useful for monitoring, controlling, saving energy, and/or reducing carbon emissions.

### EoLI: End of Life Instructions

Available at the click of a button, these instructions provide:

- Recyclability rates for Schneider Electric products.
- Guidance to mitigate personnel hazards during the dismantling of products and before recycling operations.
- Parts identification for recycling or for selective treatment, to mitigate environmental hazards/ incompatibility with standard recycling processes.

Life Is On

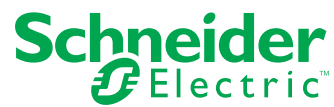

[schneider-electric.co.in](http://schneider-electric.co.in)

**Schneider Electric India Pvt. Ltd.**

**Corporate office:**

9th floor, DLF Building No. 10,  
Tower C, DLF Cyber City, Phase II,  
Gurgaon - 122002, Haryana.

Tel: 0124 3940400, Fax: 0124 4222036

**Customer Care Centre:**

Toll-free numbers: 1800 425 4272, 1800 103 0011

General number: 0124 4222 040

Email: [in.campaign@schneider-electric.com](mailto:in.campaign@schneider-electric.com)

# Acti 9

Advanced Communication

Technology that Inspires.....



Leading Future....

>Innovative >Efficient >Reliable

**Schneider**  
Electric

# About Schneider Electric

## About Schneider Electric

As a global specialist in energy management, Schneider Electric offers integrated solutions across multiple market segments, including leadership positions in energy and infrastructure, industrial processes, building automation, and data centres/networks, as well as a broad presence in residential applications.

Focused on making energy safe, reliable, and efficient, the Company is committed to help individuals and organizations "Make the most of their energy".



## Our presence worldwide and in India

### Schneider Electric Worldwide

22.4  
billion sales in 2011



394  
Rank in Fortune 500 ranking



39  
% of sales in new economies



4-5%  
Revenue devoted to R&D



130000 +  
people in 100+ countries



### Schneider Electric in India\*

17000 +  
employees



31  
Global Manufacturing Plants



10 +  
Distribution Centres



1000 +  
R&D engineers in Bangalore



1  
Regional Project & Engineering Centre



\*Figures as on April 2012

# Acti 9

Advanced Communication

Technology that Inspires.....

Total Communication from  
POWER to **FINAL Distribution**



1995  
Masterpact NT/NW  
ACBs



2005  
Compact NSX  
MCCBs



2012

>Acti 9

MCBs, RCDs, DBs



# 5 generations

of industry experience make Acti 9 the new reference in low-voltage modular systems

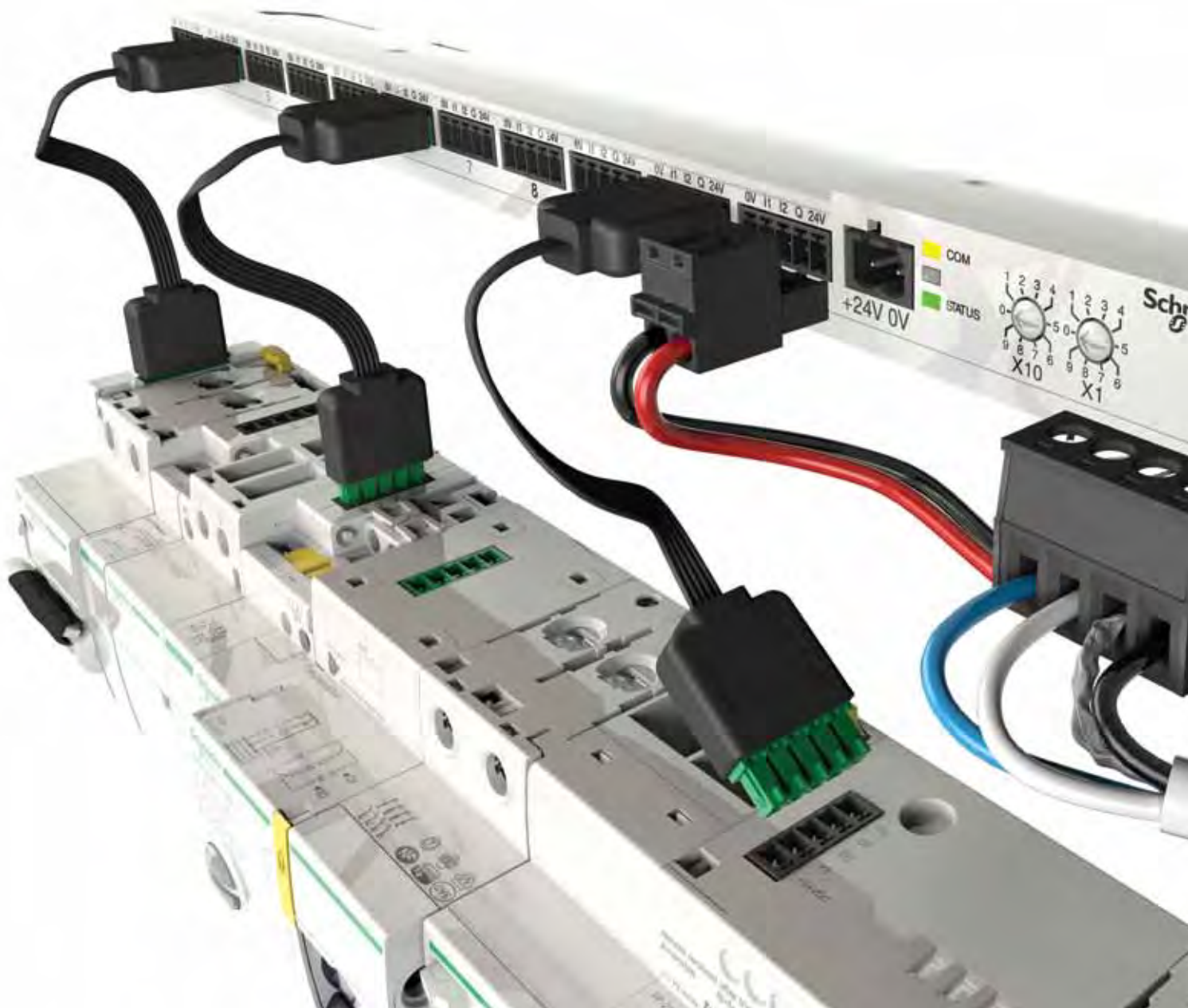

# Acti 9 | Advanced Communication Technology that Inspires

## > Protection devices

- Miniature circuit breaker
- Residual current circuit breaker
- Vigi™ residual current devices
- Surge arrester

## > Protection monitoring and supervision

- Indication and tripping auxiliaries
- Remote control auxiliaries
- Automatic recloser auxiliaries



### Innovative

Protection monitoring, Total control and Metering @ DB level



### Efficient

Manage loads, reduce operating and project costs, and accurately plan maintenance

## > Control and monitoring

- Contactors
- Impulse relays
- Integrated control circuit breaker
- Light indicators
- Push-buttons and selector switches
- Kilowatt hour meters
- Communicating architecture

## > Installation system

- Installation system
- IP20B terminals
- Splitter block
- Full range of mounting and wiring accessories



### Reliable

Dual certifications for one product, 100 percent MCB and RCD  
Coordination, easy ordering and design, error free fast connections



# Contents

---

<b>Protection Devices</b>	<b>3-20</b>
MCBs	3
RCDs	9
SPDs	15
Auxiliaries	19
<hr/>	
<b>Control &amp; Indication Devices</b>	<b>21-35</b>
<b>Communication Ready Devices</b>	<b>22-29</b>
Reflex iC60	24
iCT Contactors	25
iTL Impluse Relays	26
Smartlink	27
Energy Meters	28
Auxiliaries and Accessories	29
<b>Basic Control &amp; Indication Devices</b>	<b>30-35</b>
Isolators	30
Changeover Switches	31
Push buttons	32
Indicators	33
Bells and Buzzers	34
Time Switches	35
<hr/>	
<b>Technical Information</b>	<b>36-63</b>
Dimensions	36
Complimentary Technical Information	41
Protection Discrimination	53
Cascading	59
<hr/>	
<b>Applications</b>	<b>65-68</b>

New  
range of MCBs,  
RCDs and DBs



## Global range for Indian Installations

- > **MCBs suitable for higher ambient temperature**
  - No De-rating required till 50°C
- > **SI version RCDs now also suitable for adverse environmental conditions**
  - Assured protection in electrically polluted networks
  - Enhanced protection in corrosive and humid environment
- > **Widest product range for every application**
  - MCBs from 0.5A to 125A with 10kA to 50kA breaking capacity
  - RCDs upto 125A with 10mA – 1000mA sensitivity
  - SPDs, Auxiliaries and accessories, Control and Indication devices



### Green Products

100% Recyclable and Recoverable  
REACH and RoHS compliant

# Protection Devices

## Miniature Circuit Breakers (MCBs)



- > Protection against Overload and Short Circuit current fault
- > Protection of people against indirect contact in IT and TN earthing systems
- > Suitability for isolation in the industrial sector to IEC/EN 60947-2

### Key Benefits

- Widest range: Precise solution for all application
  - > 0.5A to 125A
  - > High breaking capacity range - from 10kA to 50kA
- Low cost with higher performance: Cascading
  - Cascading charts available From ACB-MCCB-MCB level
- Reduce Downtime: Discrimination
  - Discrimination charts available From ACB-MCCB-MCB level
- Easy Installation: Bi – connect terminals
- Increased service life: Fast Closing mechanism
- Field fittable auxiliaries available for advance protection and monitoring
- Field fittable Comm ready auxiliary for remote monitoring of:
  - Status of MCB - ON / OFF / Trip
  - Number of ON / OFF operations
  - Number of tripping due to faults
  - Number of running hours



### Green Products

100% Recyclable and Recoverable  
REACH and RoHS compliant

Suitable for

ComReady Auxiliary



# Protection Devices

## Miniature Circuit Breakers (MCBs)

### xC60

10kA - IS/IEC 60898-1; IEC/EN 60898-1

15kA - IEC 60947-2







#### Key Features

- Ensures no accidental contact with live part - Finger-proof IP-20 terminals
- Operational Safety at the downstream - Suitability for Isolation
- Avoids false insertion of cables and loose termination : Pull up terminals
- Total Flexibility : Line-Load reversibility
- Field fittable auxiliaries available for advanced protection & monitoring
- Flexible termination of Busbars and Cables - Bi-Connect terminals
- Suitable for DC application (60VDC/pole)
- Breaking Capacity enhanced to 25kA as per IEC 60947 when backed by Compact NSX MCCBs

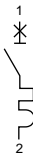
#### Technical Data

Parameter	xC60 MCB
Current Rating	0.5-63A
Poles	1,2,3,4
Rated Voltage	240-415V
Terminal Capacity	Rigid cables upto 35 sqmm Flexible cables upto 25 sqmm
Impulse Withstand Voltage	6KV
Breaking Capacity	10KA as per IEC-60898-1 15KA as per IEC-60947-2
Limitation Class	3
Operating Temperature	-25 to 70°C

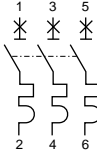

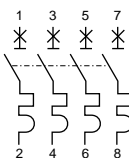
MCB xC60					
Poles	Rating (A)	References			Module Width
		B Curve	C Curve	D Curve	
 	0.5	-	A9N1PD5C	-	1
	1	-	A9N1P01C	A9N1P01D	1
	2	-	A9N1P02C	A9N1P02D	1
	3	-	A9N1P03C	A9N1P03D	1
	4	-	A9N1P04C	A9N1P04D	1
	6	A9N1P06B	A9N1P06C	A9N1P06D	1
	10	A9N1P10B	A9N1P10C	A9N1P10D	1
	16	A9N1P16B	A9N1P16C	A9N1P16D	1
	20	A9N1P20B	A9N1P20C	A9N1P20D	1
	25	A9N1P25B	A9N1P25C	A9N1P25D	1
	32	A9N1P32B	A9N1P32C	A9N1P32D	1
	40	A9N1P40B	A9N1P40C	A9N1P40D	1
	50	A9N1P50B	A9N1P50C	A9N1P50D	1
	63	A9N1P63B	A9N1P63C	A9N1P63D	1
 	0.5	-	A9N2PD5C	-	2
	1	-	A9N2P01C	A9N2P01D	2
	2	-	A9N2P02C	A9N2P02D	2
	3	-	A9N2P03C	A9N2P03D	2
	4	-	A9N2P04C	A9N2P04D	2
	6	A9N2P06B	A9N2P06C	A9N2P06D	2
	10	A9N2P10B	A9N2P10C	A9N2P10D	2
	16	A9N2P16B	A9N2P16C	A9N2P16D	2
	20	A9N2P20B	A9N2P20C	A9N2P20D	2
	25	A9N2P25B	A9N2P25C	A9N2P25D	2
	32	A9N2P32B	A9N2P32C	A9N2P32D	2
	40	A9N2P40B	A9N2P40C	A9N2P40D	2
	50	A9N2P50B	A9N2P50C	A9N2P50D	2
	63	A9N2P63B	A9N2P63C	A9N2P63D	2
 	0.5	-	A9N3PD5C	-	3
	1	-	A9N3P01C	A9N3P01D	3
	2	-	A9N3P02C	A9N3P02D	3
	3	-	A9N3P03C	A9N3P03D	3
	4	-	A9N3P04C	A9N3P04D	3
	6	A9N3P06B	A9N3P06C	A9N3P06D	3
	10	A9N3P10B	A9N3P10C	A9N3P10D	3
	16	A9N3P16B	A9N3P16C	A9N3P16D	3
	20	A9N3P20B	A9N3P20C	A9N3P20D	3
	25	A9N3P25B	A9N3P25C	A9N3P25D	3
	32	A9N3P32B	A9N3P32C	A9N3P32D	3
	40	A9N3P40B	A9N3P40C	A9N3P40D	3
	50	A9N3P50B	A9N3P50C	A9N3P50D	3
	63	A9N3P63B	A9N3P63C	A9N3P63D	3
 	0.5	-	A9N4PD5C	-	4
	1	-	A9N4P01C	-	4
	2	-	A9N4P02C	A9N4P02D	4
	3	-	A9N4P03C	A9N4P03D	4
	4	-	A9N4P04C	A9N4P04D	4
	6	A9N4P06B	A9N4P06C	A9N4P06D	4
	10	A9N4P10B	A9N4P10C	A9N4P10D	4
	16	A9N4P16B	A9N4P16C	A9N4P16D	4
	20	A9N4P20B	A9N4P20C	A9N4P20D	4
	25	A9N4P25B	A9N4P25C	A9N4P25D	4
	32	A9N4P32B	A9N4P32C	A9N4P32D	4
	40	A9N4P40B	A9N4P40C	A9N4P40D	4
	50	A9N4P50B	A9N4P50C	A9N4P50D	4
	63	A9N4P63B	A9N4P63C	A9N4P63D	4

\*\*Module width - 18mm/Module

# Protection Devices

## Miniature Circuit Breakers (MCBs)

### C120

10kA & 15kA

IEC/EN-60898-1, IEC 60947-2





#### Key Features

- C120N/H are higher rating MCBs for Overload and short-circuit protection
- Ensures no accidental contact with live part - Finger-proof IP-20 terminals
- Avoids false insertion of cables and loose termination : Pull up terminals
- Total Flexibility : Line-Load reversibility
- Operational Safety at the downstream - Suitability for Isolation
- Field fittable auxiliaries available for advanced protection
- Longer product service life : Good overvoltage withstand capacity: products designed to offer a high industrial performance level

#### Technical Data

Parameter	C120N	C120H
Current Rating	80,100,125	80,100,125A
No. of Poles	1,2,3,4	1,2,3,4
Rated Voltage	240/415V	240/415V
Terminal Capacity	Rigid upto 50 sqmm Flexible upto 35 sqmm	Rigid upto 50 sqmm Flexible upto 35 sqmm
Impulse Withstand Voltage	6KV	6KV
Breaking Capacity	10KA as per IEC 60898-1	15KA per IEC 60898-1
Energy limiting class	3	3
Operating Temperature	-30 to 70°C	-30 to 70°C



MCB C120		C120N		C120H		Module Width
Poles	Rating (A)	References		C Curve		
 	80	A9N18357	A9N18446	1.5		
	100	A9N18358	A9N18447	1.5		
	125	A9N18359	A9N18448	1.5		
 	80	A9N18361	A9N18457	3		
	100	A9N18362	A9N18458	3		
	125	A9N18363	A9N18459	3		
 	80	A9N18365	A9N18468	4.5		
	100	A9N18367	A9N18469	4.5		
	125	A9N18369	A9N18470	4.5		
 	80	A9N18372	A9N18479	6		
	100	A9N18374	A9N18480	6		
	125	A9N18376	A9N18481	6		

\*\*Module width - 18mm/Module

## Protection Devices

### Miniature Circuit Breakers (MCBs)

## C60H-DC

250Vdc per Pole

IEC/EN 60947-2

Exclusively designed to take care of all issues in DC installations to ensure complete Short circuit and Overload Protection





#### Key Features

- Widest Range - 0.5A to 63A
- Ensures no accidental contact with live part - Finger-proof IP-20 terminals
- Avoids false insertion of cables and loose termination: Pull up terminals:
- Operational Safety at the downstream - Suitability for Isolation
- Field fittable auxiliaries available for advanced protection & monitoring

#### Technical Data

Parameter	C60H-DC
No of Poles	1,2
Rated Voltage	250VDC (1P) 500VDC (2P)
Terminal Capacity	Rigid upto 35 sqmm Flexible upto 25 sqmm
Impulse Withstand Voltage	6kV
Breaking Capacity	6kA
Energy limiting class	3
Operating Temperature	-25 to 70°C



MCB C60H-DC		1P		2P		
Poles		Rating (A)	References			
			Curve C			
 1P		0.5	A9N61500		A9N61520	
		1	A9N61501		A9N61521	
		2	A9N61502		A9N61522	
		3	A9N61503		A9N61523	
		4	A9N61504		A9N61524	
		5	A9N61505		A9N61525	
		6	A9N61506		A9N61526	
		10	A9N61508		A9N61528	
		13	A9N61509		A9N61529	
		15	A9N61510		A9N61530	
		16	A9N61511		A9N61531	
		20	A9N61512		A9N61532	
		25	A9N61513		A9N61533	
		30	A9N61514		A9N61534	
 2P		32	A9N61515		A9N61535	
		40	A9N61517		A9N61537	
		50	A9N61518		A9N61538	
		63	A9N61519		A9N61539	
		Module Width		1	2	

\*\*Module width - 18mm/Module

**NG125N (25kA) MCB**



(NG125N 4P)

Current Rating	10-125A
Poles	1/2/3/4P
Rated Voltage	240/415V
Tripping Curves	B,C,D
Thermal Tripping	40°C
Breaking Capacity	25KA
Degree of Pollution	3
Operating Temperature	-30 to +70°C
Standard	IEC/EN 60947-2

**NG125H (36kA) MCB**



(NG125H 4P)

Current Rating	10-80A
Poles	1,2,3,4 P
Rated Voltage	240/415V
Tripping Curves	C
Thermal Tripping	40°C
Breaking Capacity	36KA
Degree of Pollution	3
Operating Temperature	-30 to +70°C
Standard	IEC/EN 60947-2

**NG125L(50kA) MCB**



Current Rating	10-80A
Poles	1,2,3,4P
Rated Voltage	240/415V
Tripping Curves	B,C,D
Thermal Tripping	40°C
Breaking Capacity	50KA
Degree of Pollution	3
Operating Temperature	-30 to +70°C
Standard	IEC/EN 60947-2

**UL MCB**



Type	UL_1077 MCB	UL_489 MCB
Poles	1,2,3,4	1,2,3
Tripping Curves	B,C	C
Voltage Rating	240/415	240/415V
Breaking Capacity	10kA	10kA
Degree of Pollution	3	3
Operating Temperature	(-30 to 70°C)	(-30 to 70°C)
Standard	IEC 60947-2/UL 1077/CSA	IEC 60947-2/ UL 489

**C60NA-DC**



Operating voltage (Ue)	20 A: 650 V DC
	30 A: 500 V DC
	40 A: 400 V DC
	50 A: 300 V DC
Rated insulation voltage (Ui)	1,000 V DC
Rated operational current (Ie)	50A
Impulse voltage (Uimp)	6kV
Number of poles	2P
Standards	IEC/EN 60947-3

\*\* For more details Please contact Schneider-Electric Customer Care Centre (Email: [customer care.in@schneider-electric.com](mailto:customer care.in@schneider-electric.com))

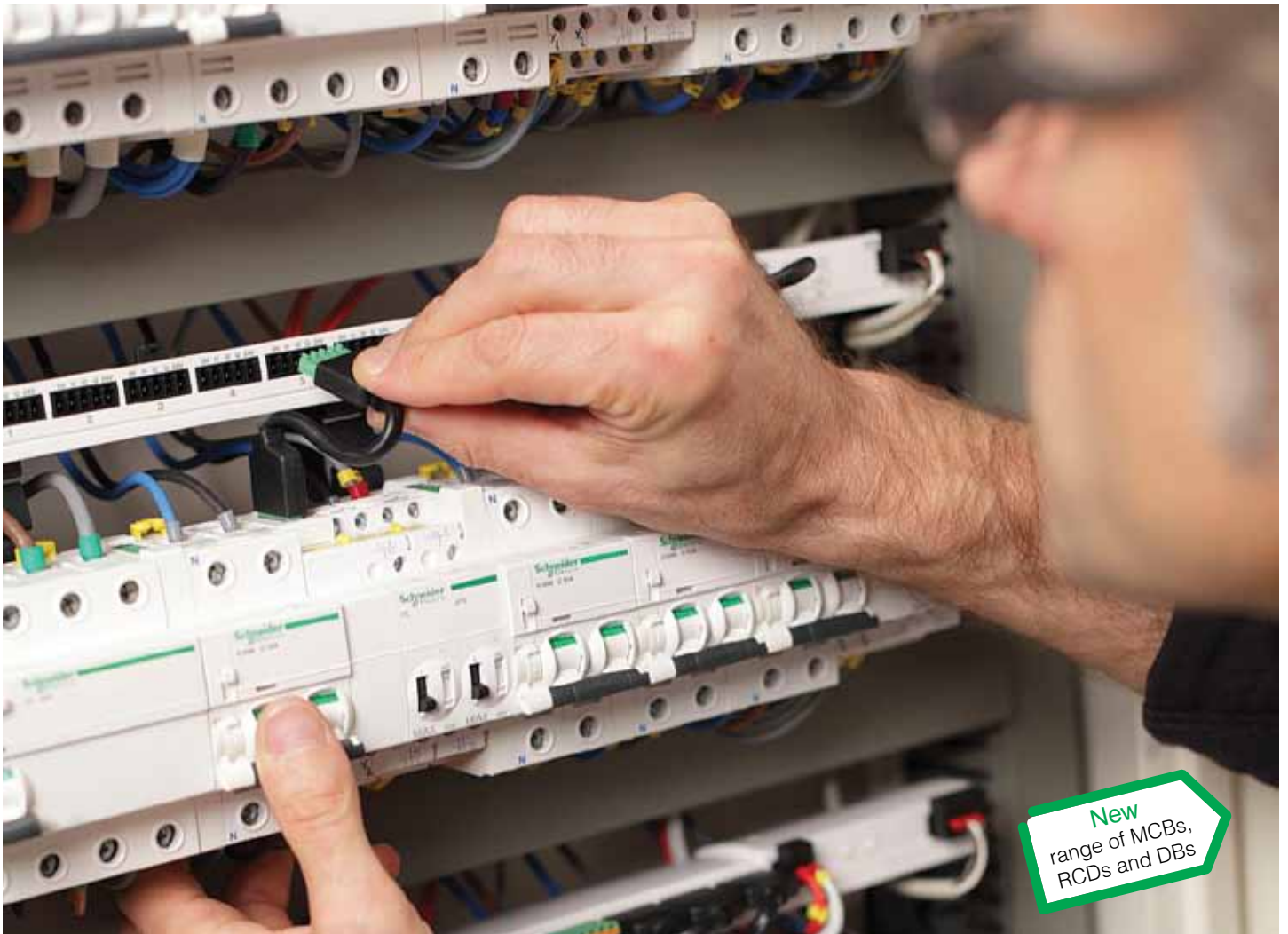

New  
range of MCBs,  
RCDs and DBs

## Build your Installation Efficiently

- > **Cost Efficient**
  - Upto 40%\* reduction in Control & Power wiring
  - Upto 25% savings on Installation cost by replacing conventional electrical panels by Distribution Boards
- > **Time Efficient**
  - Upto 15%\* time savings on Design and Installation by using smart connections with pre-fabricated wiring
- > **Space Efficient**
  - Upto 35%\* reduction in space utilization by using modular FD range



### Green Products

100% Recyclable  
and Recoverable  
REACH and RoHS  
compliant

\* Over conventional communication system

# Control and Indication Devices

## Basic Control and Indication Devices

# xSW Isolators

IEC 60669-1; IEC 60947-3









### Key Features

- Utilization category: AC-22
- Suitable for DC supply 1P - 48V DC, 2P (in series) - 110V DC
- Short circuit withstand 20In for 1sec.
- Operational Safety at the downstream - Suitability for Isolation

### Technical Data

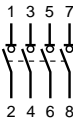
Current Rating	40A to 125A
Rated Voltage	240-415 VAC
Insulated Voltage	500V AC
Impulse Withstand Voltage	6kV
Permissible rated short-time withstand current (I <sub>cw</sub> )	1.25kA for 40A 2.5kA for 63-125A
Pollution Degree	3
Operating Temperature	-20 to 50°C

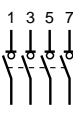

Isolators					
xSW Biconnect					
Poles		Rating	Reference Number	Module Width	
2P			40A	A9S2P040	2
			63A	A9S2P063	2
			80A	A9S2P080	2
3P			40A	A9S3P040	3
			63A	A9S3P063	3
4P			40A	A9S4P040	4
			63A	A9S4P063	4
			80A	A9S4P080	4
xSW Monoconnect					
2P			100A	A9S2P100	2
			125A	A9S2P125	2
4P			100A	A9S4P100	4
			125A	A9S4P125	4